

FLOS

05.5120.14.DA Black

Find Me 2 Dali Dimmable NEW

Designed by FLOS Architectural, 2023



LED - Power LED - 10.5W - 479lm - 2700K - CRI> 90 - Beam° 10

LED projection lighting module for installation in the Zero Track Pro system. Electronic DC/DC converter incorporated. Individual control via DALI protocol and broadcast mode via 1-10V. Accessories included (honeycomb grid and protection bar).

Are you a professional and your project needs consulting and support?

[BOOK AN APPOINTMENT](#)

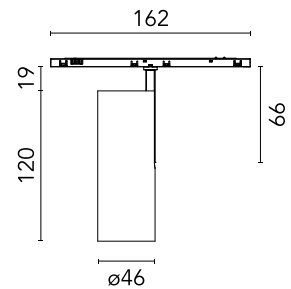

Main specifications

Mounting	Track
Environments	Indoor dry location
LED type	Power LED
Lamp category	LED
Number of heads	1
Power (W)	10.5
Source flux (lm)	724
System flux (lm)	479
Efficacy (lm/W)	46

Physical

Colour	Black
Orientation	Adjustable
Rotation (°)	360
Longitudinal tilting (°)	90
Net weight (kg)	0.3
IP internal	20

Download

Mounting instructions [↓ PDF](#)

Photometric Files

LDT / IES [↓ ZIP](#)

Technical Drawings

2D [↓ ZIP](#)

3D [↓ ZIP](#)



Ecodesign and Energy Labelling

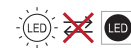

Non-replaceable light source

Schematic light drawing

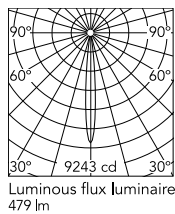

h(m)	E(lx)	D(m)
1	9243	0.18
2	2311	0.35
3	1027	0.53
4	578	0.70
5	370	0.88

Photometric

Lighting type	Direct
Light distribution	Symmetric
CCT (K)	2700
CRI>	90
McAdam steps (SDCM)	2
Beam angle C0-180 (°)	10
Beam angle C90-270 (°)	10

Electrical

Insulation class	III
Forward voltage (V)	24
LED current (mA)	760
Driver	Remote excluded
Dimmable	Yes
Dimming type	Dimmable DALI 2
Dimming range (%)	1-100
Dimming interface	Remote Dimmable (Dimmer Not Included)