

FLOS

03.9455.40ACB White/White

Light Shadow Adjustable No Trim Casambi Version 8 Spots Optic Flood

NEW

Designed by FLOS Architectural



Recessed integrated luminaire with 8 LED lighting spots. Remote power supply included (220-240V).

Are you a professional and your project needs consulting and support?

BOOK AN APPOINTMENT

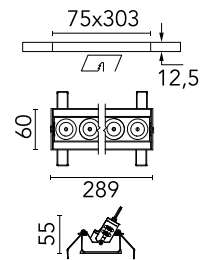

Main specifications

Mounting	Ceiling recessed
Environments	Indoor dry location
LED type	Power LED
Lamp category	LED
Number of heads	1
Power (W)	21.6
Source flux (lm)	2280
System flux (lm)	1872

Physical

Colour	White/White
Trim	No
Orientation	Adjustable
Longitudinal tilting (°)	30
Recessed depth (mm)	75
Length (mm)	289
Net weight (kg)	0.5
IP internal	20

Download

Mounting instructions [ZIP](#)

Photometric Files

LDT / IES [ZIP](#)

Technical Drawings

2D [ZIP](#)

3D [ZIP](#)

[Bim](#) [ZIP](#)



Schematic light drawing

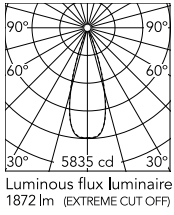

Beam Angle: 33°

h(m)	E(lx)	D(m)
1	5835	0.59
2	1459	1.18
3	648	1.78
4	365	2.37
5	233	2.96

Photometric

Lighting type	Direct
Light distribution	Symmetric
CCT (K)	3000
CRI>	90
Beam angle C0-180 (°)	33
Beam angle C90-270 (°)	33

Electrical

Insulation class	II
Frequency (Hz)	50/60
Main voltage (Vac)	220
Alternating current voltage (Vac)	230
LED voltage Vf (Vdc)	24
Driver	Remote included
Dimmable	Yes
Dimming type	Dimmable Casambi

Ecodesign and Energy Labelling



Replaceable (LED only) light source by a professional



Replaceable control gear by a professional

Notes

It requires a pre-installation frame, to be ordered separately.

Accessories & Power Supply



REQUIRED
Frame

Installation

08.0517.00

Pre-installation No Trim Frame 8L
Fix Adjustable



OPTIONAL
Accessory

Mounting

08.0059.90

Accessory for mounting of No
Trim Adjustable continuous line.