

# HEXO

17-Dec.-2016

## 1.0 LED

LED 8W | 220-240VAC | 50-60Hz | COB 2-step | incl. PS | phase-cut dim

CE IP20 0.3m 36°

white texture	146564W_
gold	146564G_
bronze	146564Q_
copper	146564P_
black texture	146564B_

### LIGHT COLOUR

2700K   >80CRI   600lm	2
3000K   >80CRI   600lm	4
1800-2850K   >90CRI   410lm	9

## 1.0 PAR16

PAR16 max. 35W | GU10 | 100-240VAC | 50-60Hz

CE IP20 0.9m

white texture	146520W0
gold	146520G0
bronze	146520Q0
copper	146520P0
black texture	146520B0

### OPTIONAL

for PAR16 lamps see our catalogue

### OPTIONAL

single inner cover max. 10W

white texture	911031W1
gold	911031G1
black texture	911031B1

### base plate dimensions

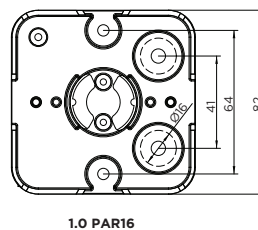
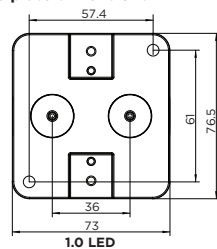

### 1.0 LED

### 1.0 PAR16

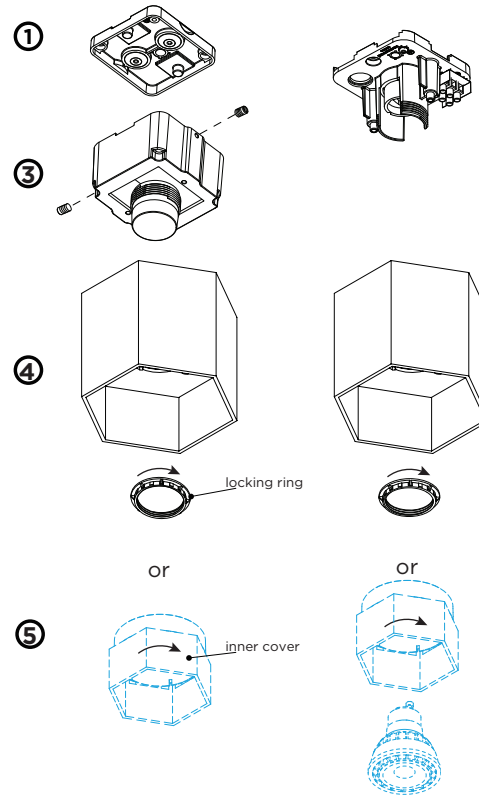

## DIMENSIONS

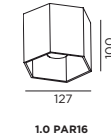
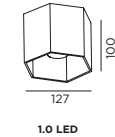

## 1 MOUNTING INSTRUCTION

Remove the screws of the top part, put the cables through the opening and mount the base on the ceiling.

## 2 POWER CONNECTION

Connect wiring to the power supply (for LED) or to terminal block (for PAR16)  
interior connection: STANDARD version

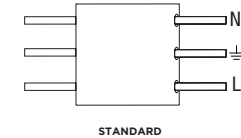

## 3 FOR LED

Attach the LED housing on the base by two allen screws.

## 4 FOR LED

Attach the HEXO cover to the LED housing by screwing the locking ring

### FOR PAR16

Attach the HEXO cover to the base by screwing the locking ring

## 5 OPTIONAL inner cover

put the inner cover in the outer cover by screwing.

with inner cover: **max. 10W**

when using the inner cover you don't need the locking ring.



WEVER & DUCRÉ  
LIGHTING

www.weverducre.com

Wever & Ducre bvba Kwadestraat 153 bus 2.1 8800 Roeselare

INSTALLATION  
INSTRUCTIONS